

ASSEMBLING INSTRUCTION

LICENSE PLATE HOLDER HUSQVARNA 701 '19

HV7104-19

KIT

X1. SPECIFIC LICENSE PLATE HOLDER KIT
X1. SPECIFIC CHAIN TENSIONER
X4. M8X16

WWW.BARRACUDAMOTO.COM

ASSEMBLING PROCEDURE:

1. REMOVE THE ORIGINAL LICENSE PLATE HOLDER.
2. ASSEMBLE THE SPECIFIC LICENSE PLATE HOLDER, USING THE SUPPLIED M8X16 SCREWS, AS ILLUSTRATED.
3. **IMPORTANT:** PLACE THE SPECIFIC CHAIN TENSIONER ON THE REAR AXLE PIN AS INDICATED, AND TIGHTEN THE ORIGINAL NUT.
4. TIGHTEN EVERYTHING.

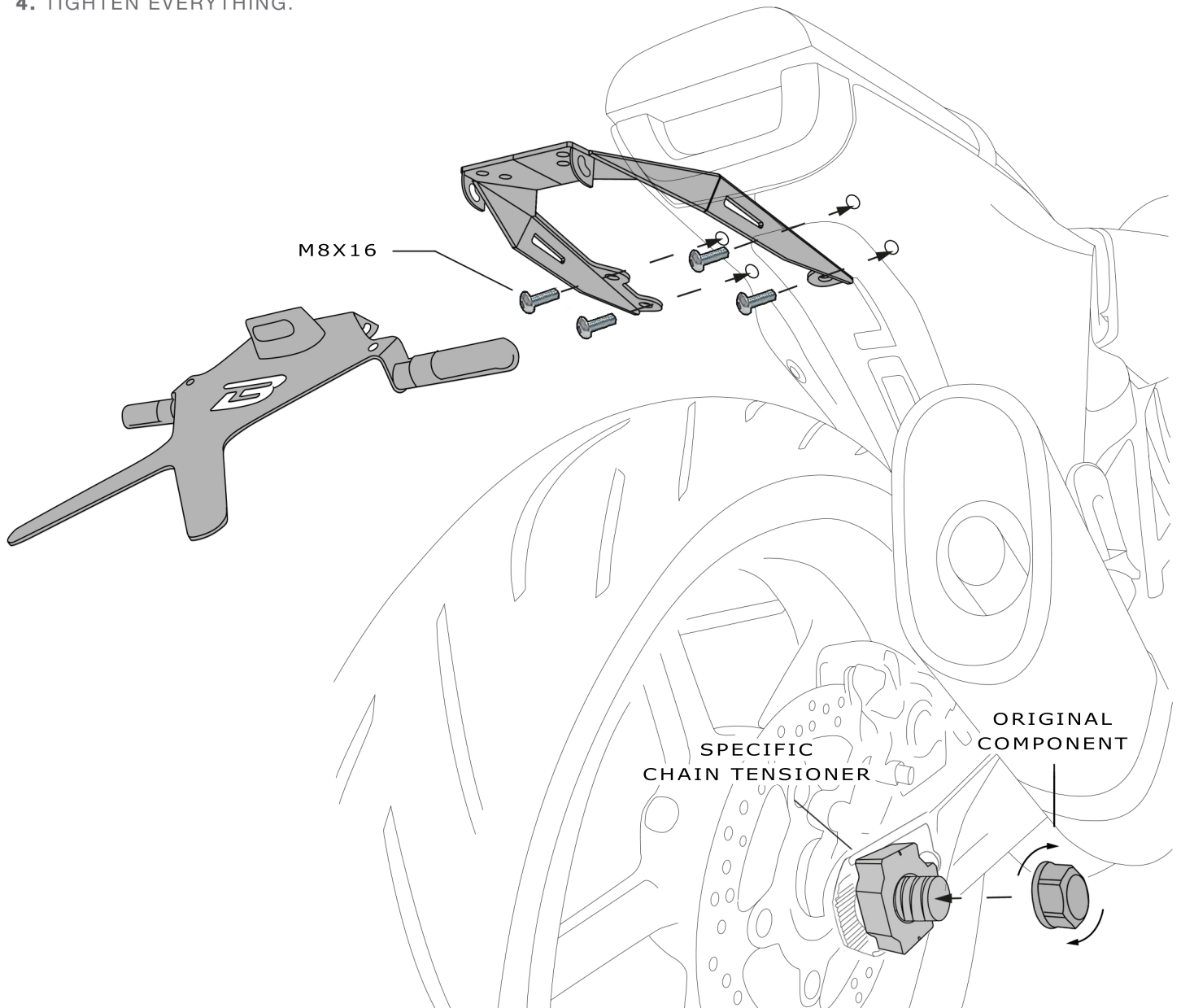

IMPORTANT: WE ADVISE AN INCLINATION NOT EXCEEDING TO 30° TO AVOID SANCTIONS AND POSSIBLE DAMAGES